

CMPS5061
 CMPS5062
 CMPS5063
 CMPS5064

**SURFACE MOUNT
 SILICON CONTROLLED RECTIFIER**

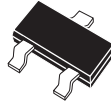

SOT-23 CASE

CentralTM Semiconductor Corp.

DESCRIPTION:

The CENTRAL SEMICONDUCTOR CMPS5061 Series types are epoxy molded PNP Silicon Controlled Rectifiers manufactured in an SOT-23 case, designed for control systems and sensing circuit applications.

MARKING CODES: CMPS5061: P2A
 CMPS5062: P2B
 CMPS5063: P2C
 CMPS5064: P2D

MAXIMUM RATINGS: (T_A=25°C)

| | SYMBOL | CMPS5061 | CMPS5062 | CMPS5063 | CMPS5064 | UNITS |
|---|-----------------------------------|----------|-------------|----------|----------|-------|
| Peak Repetitive Off-State Voltage | V _{DRM} | 100 | 200 | 300 | 400 | V |
| Peak Repetitive Reverse Voltage | V _{RRM} | 100 | 200 | 300 | 400 | V |
| RMS On-State Current | I _{T(RMS)} | | | 0.8 | | A |
| Average On-State Current (T _C =67°C) | I _{T(AV)} | | | 0.51 | | A |
| Power Dissipation | P _D | | | 350 | | mW |
| Operating and Storage | | | | | | |
| Junction Temperature | T _J , T _{stg} | | -65 to +150 | | | °C |
| Thermal Resistance | θ _{JA} | | 357 | | | °C/W |

ELECTRICAL CHARACTERISTICS: (T_A=25°C unless otherwise noted)

| SYMBOL | TEST CONDITIONS | CMPS5061 | | CMPS5062 | | CMPS5063 | | CMPS5064 | | UNITS |
|------------------|---|----------|---------|----------|---------|----------|---------|----------|---------|-------|
| | | MIN | MAX | MIN | MAX | MIN | MAX | MIN | MAX | |
| I _{DRM} | V _D =Rated V _{DRM} , R _{GK} =1KΩ | | 1.0 | | 1.0 | | 1.0 | | 1.0 | μA |
| I _{RRM} | V _D =Rated V _{DRM} , R _{GK} =1KΩ | | 1.0 | | 1.0 | | 1.0 | | 1.0 | μA |
| I _{DRM} | V _D =Rated V _{DRM} , R _{GK} =1KΩ, T _C =125°C | | 50 | | 50 | | 50 | | 50 | μA |
| I _{RRM} | V _D =Rated V _{DRM} , R _{GK} =1KΩ, T _C =125°C | | 50 | | 50 | | 50 | | 50 | μA |
| V _T | I _T =1.2A | | 1.7 | | 1.7 | | 1.7 | | 1.7 | V |
| I _{GT} | V _D =7.0V, R _L =100Ω, R _{GK} =1KΩ | | 200 | | 200 | | 200 | | 200 | μA |
| V _{GT} | V _D =7.0V, R _L =100Ω, R _{GK} =1KΩ | | 0.8 | | 0.8 | | 0.8 | | 0.8 | V |
| V _{GD} | V _D = Rated V _{DRM} , R _L =100Ω, T _C =125°C | 0.1 | | 0.1 | | 0.1 | | 0.1 | | V |
| I _H | V _D =7.0, R _{GK} =1KΩ | | 5.0 | | 5.0 | | 5.0 | | 5.0 | mA |
| t _{ON} | V _D = Rated V _{DRM} , I _{GT} =1.0mA, R _{GK} =1.0Ω, di/dt=6.0A/μs | | 2.8 TYP | | 2.8 TYP | | 2.8 TYP | | 2.8 TYP | μs |

**SURFACE MOUNT
SILICON CONTROLLED RECTIFIER**

MECHANICAL OUTLINE - SOT-23

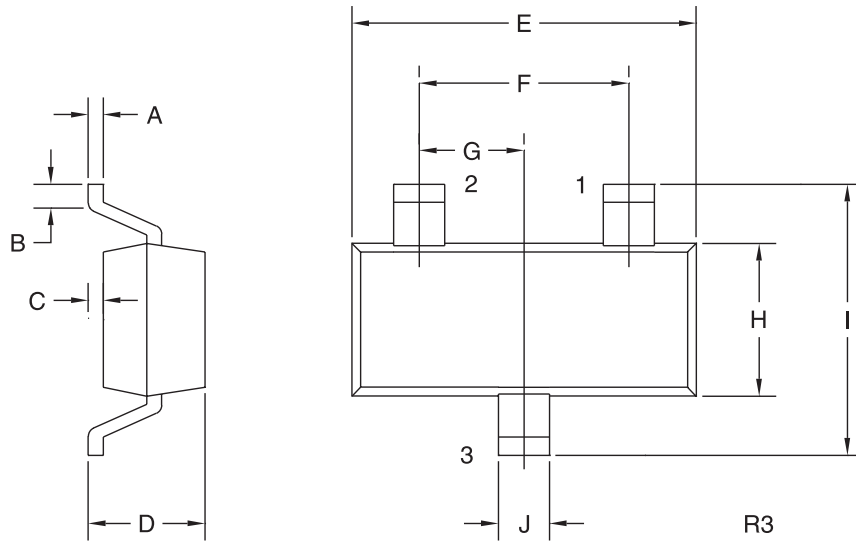

LEAD CODE:

- 1) CATHODE
- 2) GATE
- 3) ANODE

MARKING CODES:

- CMPS5061: P2A
- CMPS5062: P2B
- CMPS5063: P2C
- CMPS5064: P2D

| SYMBOL | DIMENSIONS | | | |
|--------|------------|-------|-------------|------|
| | INCHES | | MILLIMETERS | |
| | MIN | MAX | MIN | MAX |
| A | 0.003 | 0.007 | 0.08 | 0.18 |
| B | 0.006 | - | 0.15 | - |
| C | - | 0.005 | - | 0.13 |
| D | 0.035 | 0.043 | 0.89 | 1.09 |
| E | 0.110 | 0.120 | 2.80 | 3.05 |
| F | 0.075 | | 1.90 | |
| G | 0.037 | | 0.95 | |
| H | 0.047 | 0.055 | 1.19 | 1.40 |
| I | 0.083 | 0.098 | 2.10 | 2.49 |
| J | 0.014 | 0.020 | 0.35 | 0.50 |

SOT-23 (REV: R3)